



Instruction V16

FOR VOLVO CARS MANUFACTURING – INSTRUCTION FOR USING V16

October 2023

The following instructions are valid for the V16 Quickbox used for overseas shipping where it is mandatory to use according to the VOLVO CARS PACKAGING REQUIREMENT.

Maximum unit load per Quickbox is 8 kg.

Mandatory:

- To use EMB153 for pallet label.
- The correct pallet, Half pallet for Quick box, art.No 2073404
(No other pallet is allowed to use!)
- Always fill up with a full layer of boxes to make a complete layer.
If necessary fill up with empty boxes.
- Maximum layers of boxes are 4 on each pallet.
- Use top lid and two straps as shown in the instruction.
- Do not use stretch film, use 2 straps on the longside only.

If you need additional support please contact us.

customersupport.int@pacson.se

www.international.pacson.se/volvocars

V16



www.international.pacson.se/volvocars | customersupport.int@pacson.se

Instruction V16



FOR VOLVO CARS MANUFACTURING – INSTRUCTION FOR USING V16

October 2023



	Art.No	Art.No	Art.No
	Tray	Tray Lid	Pallet Lid
V16	2072672	2072680	2072736

EMB153 = Holder for Odette Label
Half pallet for Quick box Art.No 2073404

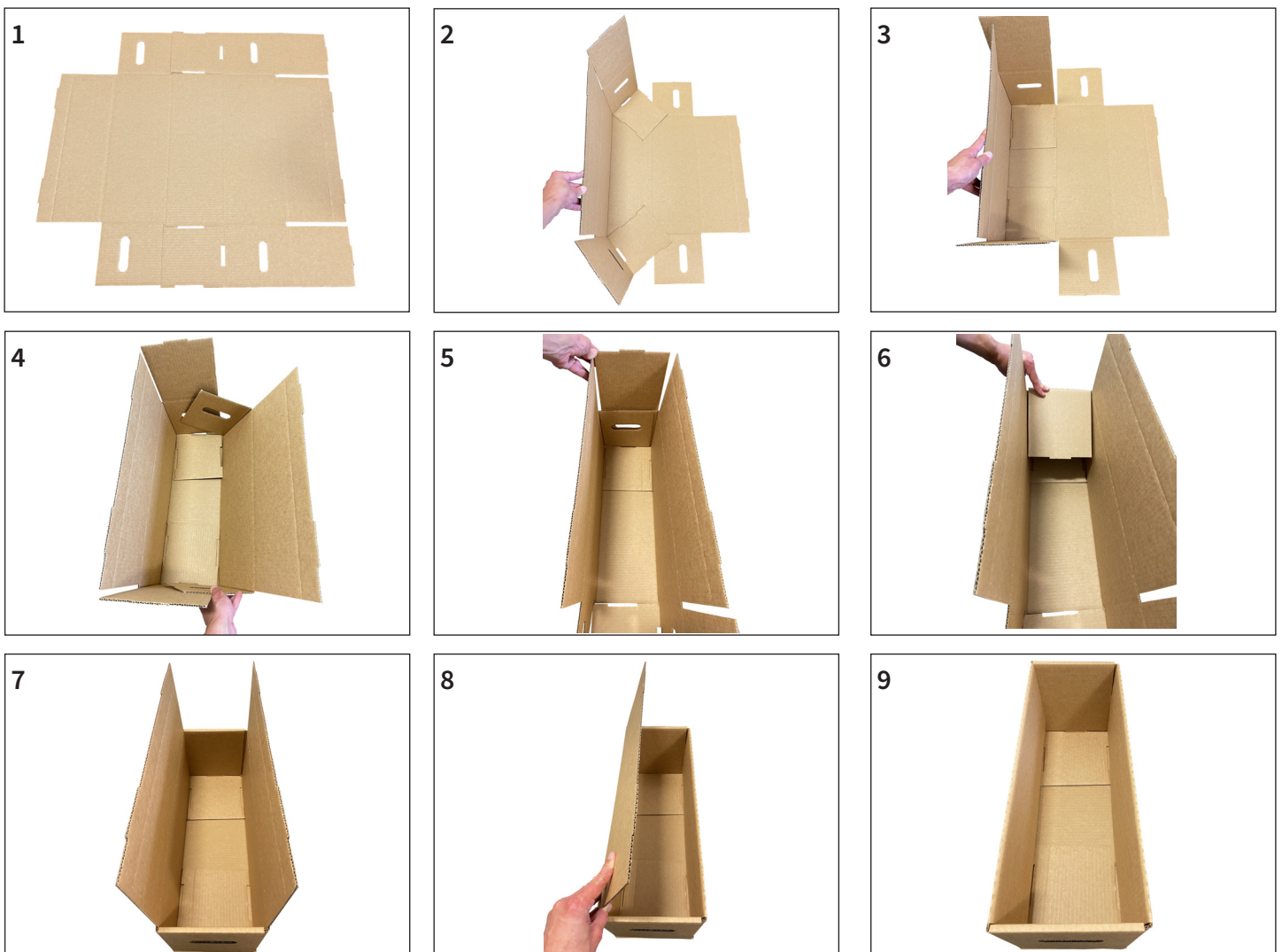

Instruction V16



FOR VOLVO CARS MANUFACTURING – INSTRUCTION FOR USING V16

October 2023



Always place the EMB153 left side for the Odette Label
- On the bottom layer
- On the box to the left at the short side of the pallet
- Use the lid Art.No 2072736

Maximum amount of cases with V16 stacked on top each other is 3 layers.

Do not stack odd size boxes on top of V16 pallets.



300 kg

300 kg

300 kg

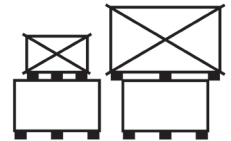

Odette Label holder Art.No EMB153



Lid Art.No 2072736



Instruction V16



FOR VOLVO CARS MANUFACTURING – INSTRUCTION FOR USING V16

October 2023

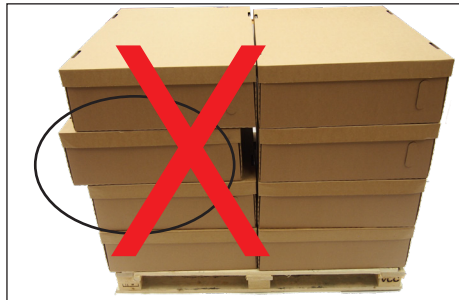

No boxes outside the pallet!

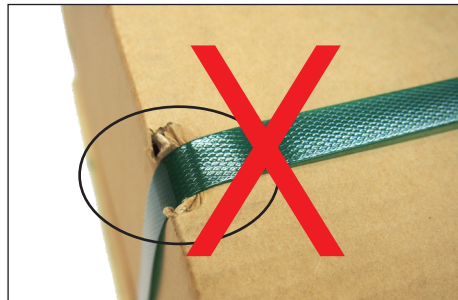

Be careful when strapping.

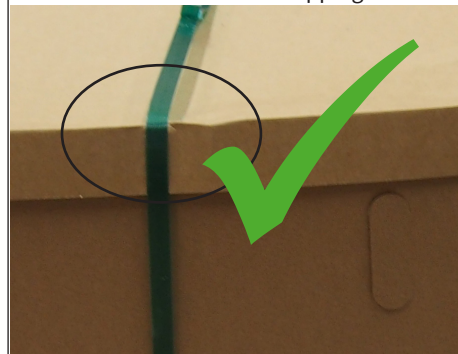

Make a flat layer using empty boxes.



Make a flat layer using empty boxes.



Use the right lid: EMB153 Odette Label Holder.



Use a top lid before you put on 2 straps.



www.international.pacson.se/volvocars | customersupport.int@pacson.se

Instruction V16



FOR VOLVO CARS MANUFACTURING – INSTRUCTION FOR USING V16

October 2023

Name	Art.No	Inside	Outside	MOQ	BCT
Tray V16 Quick Box	2072672	552x170x195	550x189x205	20	3147N/315 kg
Lid V16 Quick Box	2072680	547x187x35	558x191x39	40	
Lid Half pallet Quick box	2072736	775x562x50	790x570x54	20	
Half pallet for Quick box	2073404	–	790x570x126	15	
EMB153, Odette Label holder	EMB153	–	–	250	

